

16. SUPPLEMENT TO CB550K1

1. FUEL COCK

The fuel cock is new for the revised model. Concurrent with this change, the indication marks and their positions on fuel cock was changed.

Inspection and cleaning

1. Place the fuel lever in the "OFF" position; disconnect the fuel tubes. Take out the fuel tank.
2. Drain the fuel tank thoroughly.
3. Loosen the fuel cock fixing nut and then remove the fuel cock and fuel filter from the fuel tank.
4. Check the gasket to see if it is not damaged. Replace with a new one, if found to be damaged too badly beyond use.
5. Wash the fuel filter in solvent and dry with compressed air. Any slightest damage cannot be tolerated here. Also replace the filter with a new one if found to be clogged.
6. Install the fuel filter to the fuel cock with the fixing nut. Do not forget to install the gasket into the groove of the fixing nut.
7. Install the fuel cock to the fuel tank with the fixing nut.
8. Install the fuel tank in place on the frame; connect tubes and secure with the clips.
9. Fill the tank with fuel. With the fuel cock lever in the "ON" position, check for any leakage past the tube joints or connections.

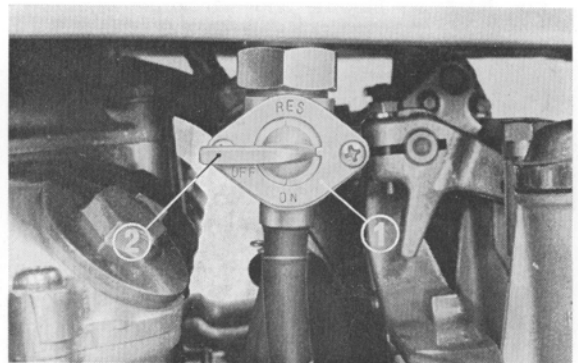

Fig. K1-1 ① Fuel cock
② Lever
③ Fuel cock fixing nut

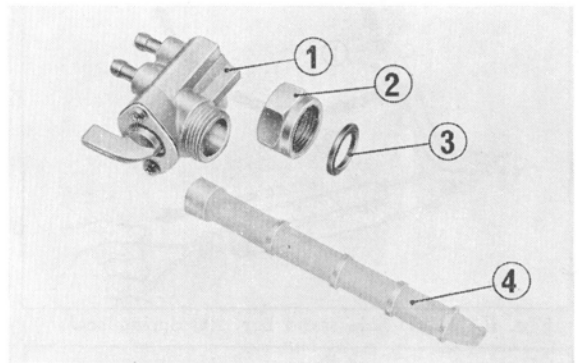

Fig. K1-2 ① Fuel cock
② Fixing nut
③ Gasket
④ Fuel filter

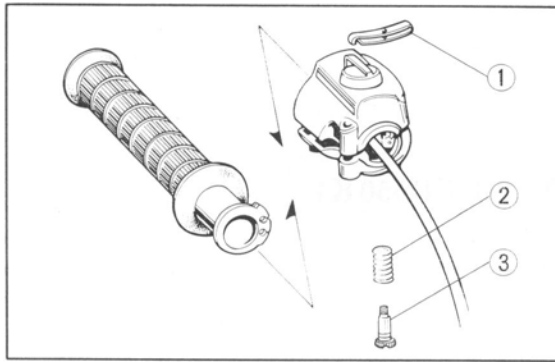

Fig. K1-3 ① Throttle grip ② Spring adjuster
③ Adjusting bolt

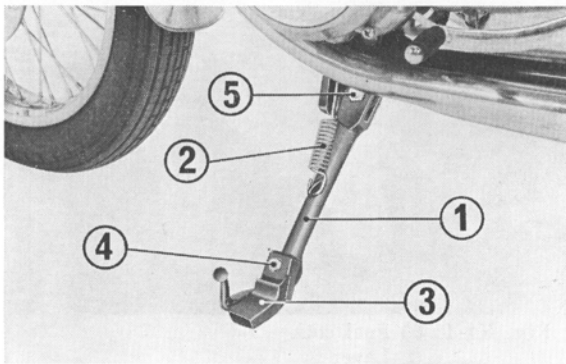

Fig. K1-4 ① Side stand bar ④ 6 mm bolt
② Spring ⑤ Side stand pivot bolt
③ Rubber pad

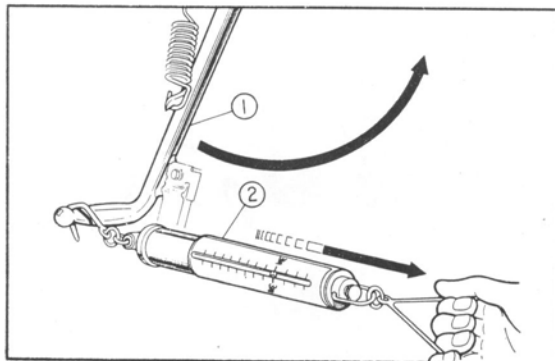

Fig. K1-5 ① Side stand bar ② Spring scale

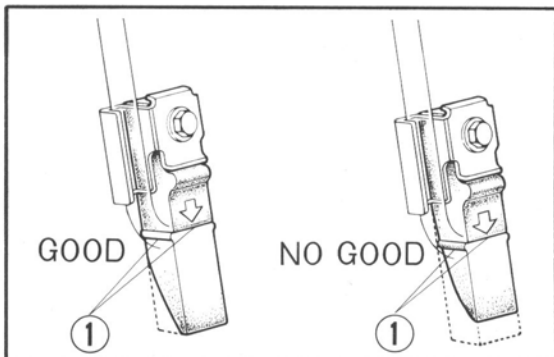

Fig. K1-6 ① Wear line

2. THROTTLE GRIP

The throttle grip adjuster, Fig. K1-3, hitherto offered, was discontinued.

3. SIDE STAND

The side stand was changed to a new type with a shock absorbing rubber pad. The side stand must be inspected periodically to determine that it is in good condition.

Inspection

1. Check the entire stand assembly (side stand bar, bracket and rubber pad) for installation, deformation or otherwise excessive damage.
2. Check the spring for freedom from damage or other defects.
3. Check the side stand for proper return operation :
 - a. With the side stand applied, raise the stand off the ground by using the main stand.
 - b. Attach a spring scale to the lower end of the stand and measure the force with which the stand is returned to its original position.
 - c. The stand condition is correct if the measurement falls within 2~3kg (4.4~6.6lbs.).

If the stand requires force exceeding the above limit, this might be due to neglected lubrication, overtightened side stand pivot bolt, worn stand bar or bracket, or otherwise excessive tension. Replace as necessary.

4. Check the rubber pad for deterioration or wear. When the rubber pad wear is excessive so that it is worn down to the wear line, replace it with a new one.

Rubber pad replacement

1. Remove the 6mm bolt; separate the rubber pad from the bracket at the side stand.
2. After making sure the collar is installed, put a new rubber pad in place in the bracket with the arrow mark out.

Note:

Use rubber pad having the mark "OVER 260 lbs ONLY".

3. Secure the rubber pad with the 6mm bolt.

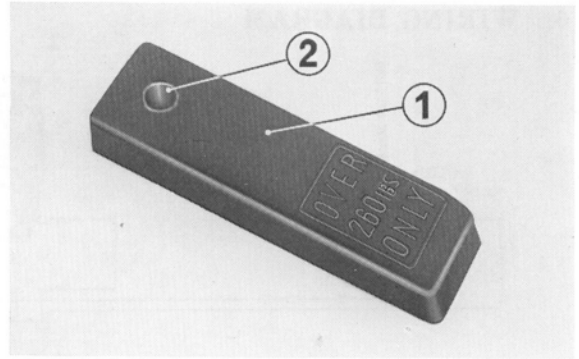

Fig. K1-7 ① Rubber pad
② Collar

4. TURN SIGNAL LIGHT

The front and rear turn signal lights were changed to new, larger types. See Figs. K1-8 and K1-9.

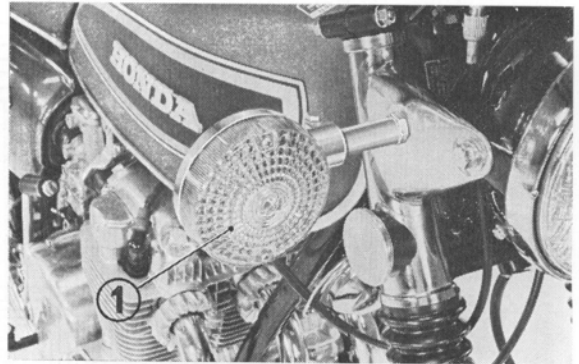

Fig. K1-8 ① Front turn signal light

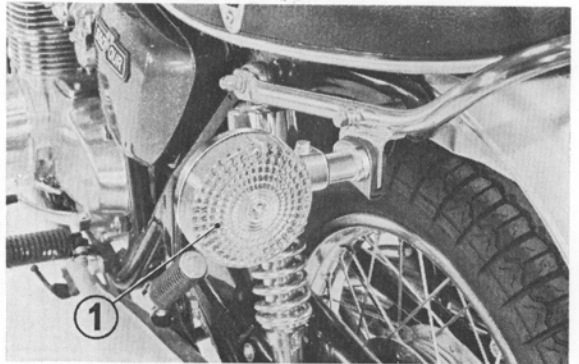

Fig. K1-9 ① Rear turn signal light

5. MAINTENANCE SCHEDULE

Some additions occurred in the MAINTENANCE SCHEDULE, of which details are as shown immediately below:

This maintenance schedule is based upon average riding conditions. Machines subjected to severe use, or ridden in unusually dusty areas, require more frequent servicing.	INITIAL SERVICE PERIOD		REGULAR SERVICE PERIOD			
			Perform at every indicated month or mileage interval, whichever occurs first.			
	500 miles		1 month 500 miles	3 months 1,500 miles	6 months 3,000 miles	12 months 6,000 miles
*SIDE STAND—Check installation, operation, deformation, damage and wear.					○	

Items marked * should be serviced by an authorized Honda dealer, unless the owner has proper tools and is mechanically proficient. Other maintenance items are simple to perform and may be serviced by the owner.

6. WIRING DIAGRAM

